

VPSE PLANSIFTER

The plansifter „VPSE“ is used to sift and sort granular and powdery products based on particle size. Depending on the design, many different products can be sifted and sorted at the same time.



FUNCTION

The product enters the machine through the round inlets and is evenly distributed on the top sieve. Due to the force of gravity and the free-swinging movement of the machine, the product slowly flows down over the various sieve levels and is guided to the correct outlets by an intelligent product guide inside the machine. Then, the different products leave the machine through a variable number of outlets. Different sieve sizes, the number of sieves and the adapted product guidance inside enable variable adaptation to the most diverse sorting tasks and products.

HYGIENE

- > Rounded corners prevent product buildup and dead corners
- > Smooth surfaces
- > Maximum tightness through the use of high-quality and durable sealing materials
- > Product touching parts in stainless steel as an option
- > Easy to clean thanks to quick removal of the sieve stack
- > Insulated walls and doors to prevent condensation

OPERATION

- > Largest screen area with minimal space requirements
- > Up to 30 sieves per compartment
- > Maximum flexibility in execution
- > Compartments that can be divided vertically and horizontally
- > Sieve boxes made of coated wood or plastic, insert frames made of aluminium
- > Suitable for use in potentially explosive areas (inside/outside)

CONSTRUCTION

- > Sturdy and durable construction
- > Modular design for maximum flexibility, also during assembly
- > Construction made of vibration-resistant special carbon steel
- > Insulated walls and doors to prevent condensation
- > Good ventilation of the sieve compartments through air-permeable inlets and outlets
- > Even product distribution on the top sieve thanks to a special product distributor

OPTIONS

- > Each machine is individually adapted to the requirements (number of sieves, sieve sizes, screen mesh, product guidance)
- > Product touching parts in stainless steel
- > Plastic sieve boxes
- > Swing width and level monitoring
- > Bearing temperature monitoring
- > Outlet monitoring with light barrier
- > Custom painting (standard: RAL9003/ RAL3003)
- > Individually designed inlet bank and sifter suspension

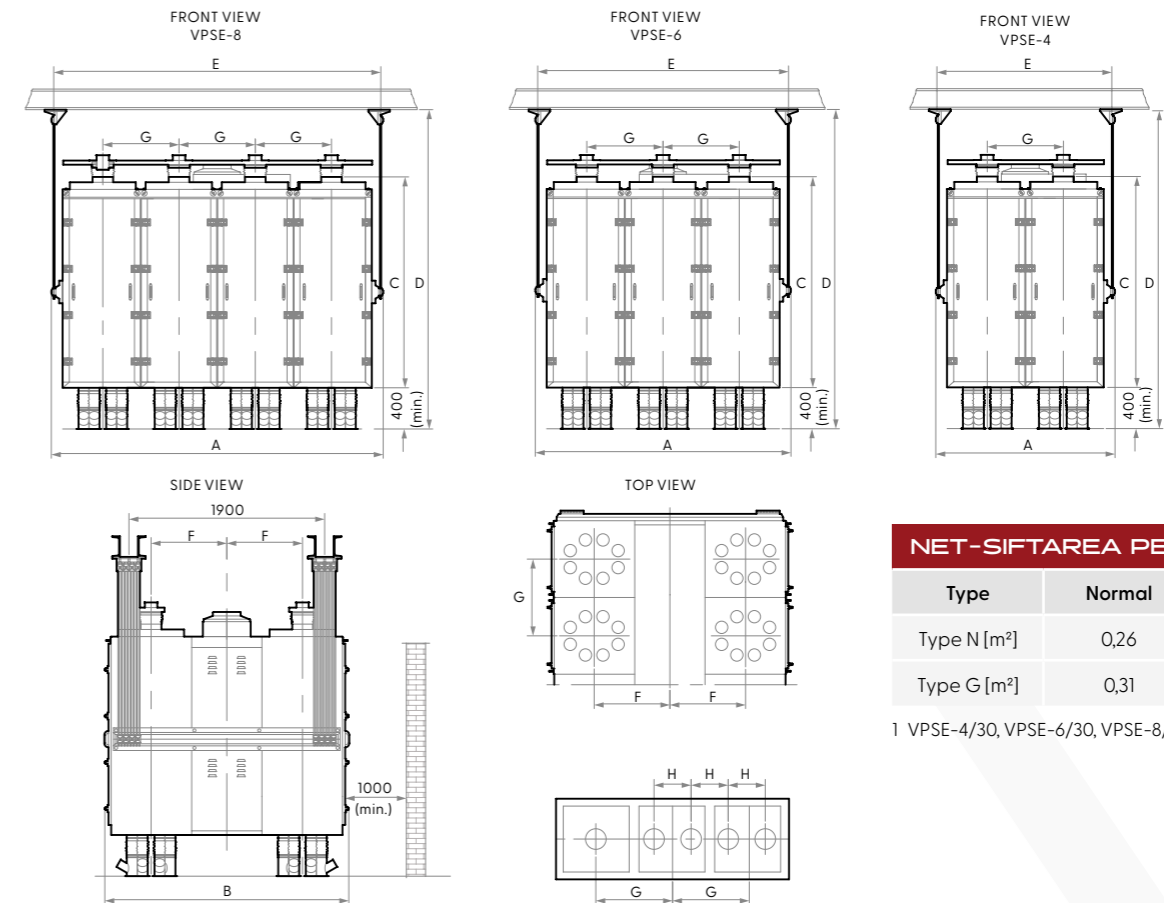

NET-SIFTAREA PER SIEVE

Type	Normal	Wide ¹
Type N [m ²]	0,26	0,32
Type G [m ²]	0,31	0,36

¹ VPSE-4/30, VPSE-6/30, VPSE-8/30

TECHNICAL DATA

Type	VPSE-4/24	VPSE-4/28	VPSE-6/24	VPSE-6/28	VPSE-8/24	VPSE-8/28	VPSE-4/30	VPSE-6/30	VPSE-8/30	
N° of compartments	4		6		8		4	6	8	
N° of sieves per compartment	20–24	24–28	20–24	24–28	20–24	24–28	30	30	30	
max. Net-Siftarea ² [m ²]	Type N	20–25	25–30	30–37,5	37,5–45	40–50	50–60	37,5	56,2	75
	Type G	24–30	30–36	36–45	45–54	48–60	60–72	43,7	65,6	87,5
Motor Power [kW]	4,0		5,5		7,5		5,5	7,5	11,0	
Weight [kg]	Net	2.500	2.750	2.770	3.710	4.425	4.850	3.550	4.578	6.345
	Gross	2.850	3.000	3.260	4.435	4.660	5.085	3.800	4.850	7.155
Volume [m ³]	11,5	13	11,5	18,5	20,2	22,9	18,1	25	32,2	

² The actual sifting area always depends on the sifter scheme and thus on the mix of the individual frame types (N and G).

DIMENSIONS (MM)

Type	VPSE-4/24	VPSE-4/28	VPSE-6/24	VPSE-6/28	VPSE-8/24	VPSE-8/28	VPSE-4/30	VPSE-6/30	VPSE-8/30
A	1.715		2.550		3.205		2.020	2.880	3.785
B	2.355		2.355		2.355		2.765	2.765	2.765
C	1.995	2.295	1.995	2.295	1.995	2.295	2.400	2.400	2.400
D	min	3.315	3.460	3.315	3.460	3.315	3.460	3.640	3.640
	max	5.215	5.360	5.215	5.360	5.215	5.360	5.640	5.640
E	1.685		2.430		3.175		1.950	2.813	3.689
F	735		735		735		892	892	892
G	745		745		745		866	866	866
H	373		373		373		440	440	440